

Scale: 1/4" = 1'-0"

APPROVED: [Signature]
 REGISTERED CIVIL ENGINEER NO. 13883
 3313
 SHEET 1 OF 1 SHEETS
 CHECKED BY: [Signature]
 RECOMMENDED BY: [Signature]

DEPARTMENT OF ENGINEERING
 CITY OF SAN BERNARDINO
 2474 ST. 157
 Bakers, D. S. H. I. E. S. A. F.
 Curb, Gutter & Fading

GENERAL NOTES
 1. All work indicated on this sheet shall be done in conformity with applicable local, state and federal specifications for the work. The specifications for the work shall be the specifications of the Department of Public Works, San Bernardino County, California.
 2. Refer to Drawings as Noted.

BENCH MARK
 S.W. CORNER 28th St.
 E.L. 1182.21

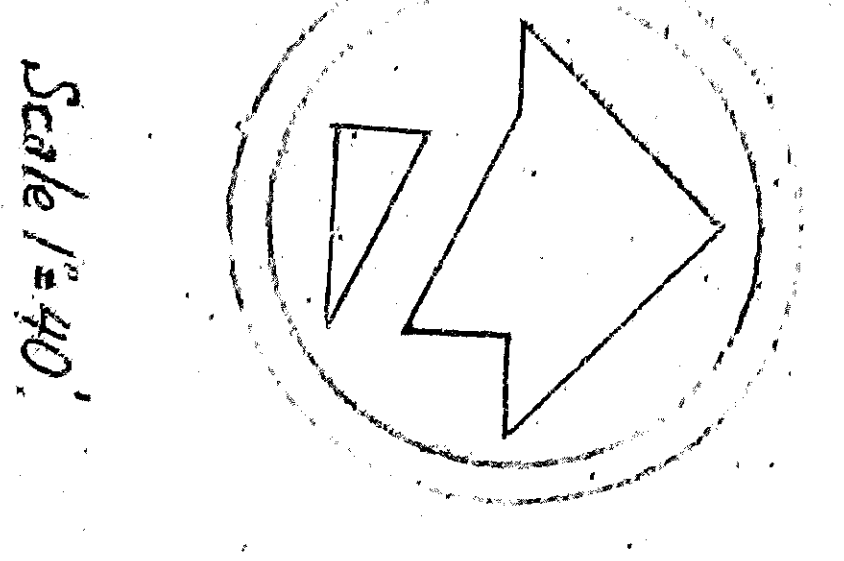


Scale: 1/4" = 1'-0"

APPROVED: *[Signature]*
 REGISTERED CIVIL ENGINEER NO. 13883
 3313
 CHECKED BY: *[Signature]*
 1 OF 1 SHEETS
 RECOMMENDED BY: *[Signature]*

DEPARTMENT OF ENGINEERING
 CITY OF SAN BERNARDINO
 2474 ST. 157
 BARNES, D. ST. 157
 CULB, GUTTER & FACING

GENERAL NOTES
 1. All work shall be done in accordance with the specifications for the project.
 2. The contractor shall be responsible for obtaining all necessary permits.
 3. The contractor shall be responsible for maintaining the existing utilities.
 4. The contractor shall be responsible for the safety of the public.
 5. The contractor shall be responsible for the quality of the work.

BENCH MARK
 S.W. CORNER 24th St.
 E.L. 1182.15